



## Model: 6" Vacuum-Assisted Solids Handling Pump

Name: 6JSVEE

With its heavy-duty construction and fast priming capabilities, the Thompson 6JSVEE solids handling end suction centrifugal pump leads the industry in construction, industrial and municipal applications. The Thompson 6JSVEE is designed for moderate flows up to 2,250 gpm and heads up to 110 feet making it perfect for sewage bypass pumping or general construction dewatering.



Photo shown may not be exact model.

Consult factory for other options including but not limited to trailers and stainless steel impellers.

Pump End Materials	
<b>Pump Casing</b>	Heavy-duty 65-45-12 ductile-iron.
<b>Impeller</b>	Dynamically balanced, non-clogging, enclosed, 65-45-12 ductile-iron with rear-equalizing vanes to reduce axial loading and prolong seal and bearing life; diameter 9.5".
<b>Mechanical Seal</b>	Dry-running, grease or oil lubricated with tungsten carbide rotating and silicon carbide stationary seal faces. Single inside mounted, non-pusher type with self-adjusting elastomeric bellows. Other components are 304 stainless-steel and Viton.
<b>Head</b>	Rugged, back pull out design, heavy-duty class 30 cast-iron with tapered bore design.
<b>Bearings</b>	Heavy-duty grease lubricated to carry both axial and radial loads.
<b>Bearing Frame</b>	Heavy-duty class 30 cast-iron.
<b>Shaft</b>	SAE 1144 high quality stress-proof steel with renewable 416 stainless-steel shaft sleeve.

Technical Specifications			
Suction Size	6 in (15.24 cm)	Approximate Dry Weight	4,100 lbs (1,859.73 kg)
Discharge Size	6 in (15.24 cm)	Best Efficiency	71%
Maximum Solids Handling	3 in (7.62 cm)	Maximum Operating Speed	2,000 rpm
Maximum Operating Temperature	200° F (93.33° C)	Maximum Operating Pressure	47 psi

Fuel Tank Options*		Isuzu
Modular (M)	100 Gal	74 Hours
Double-Wall (D)	75 Gal	55 Hours
Modular Large Capacity (X)	150 Gal	111 Hours
Double-Wall Large Capacity (Z)	150 Gal	111 Hours

\*Contact factory for fuel tank sizes not listed above.

**Thompson Pump and Manufacturing Co., Inc.**  
4620 City Center Drive, Port Orange, FL 32129 USA  
www.thompsonpump.com

Nationwide 800-767-7310 • International +1-386-767-7310  
sales@thompsonpump.com Feb-23

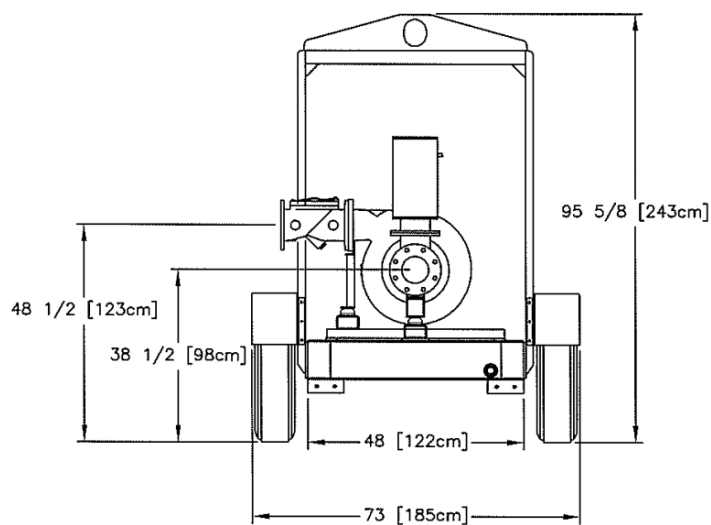
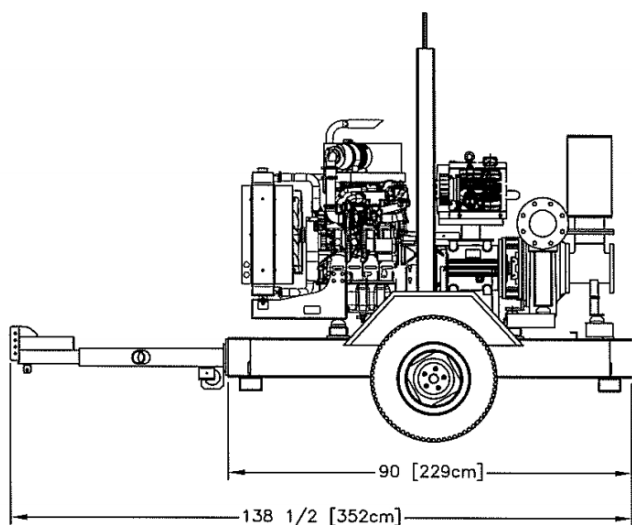
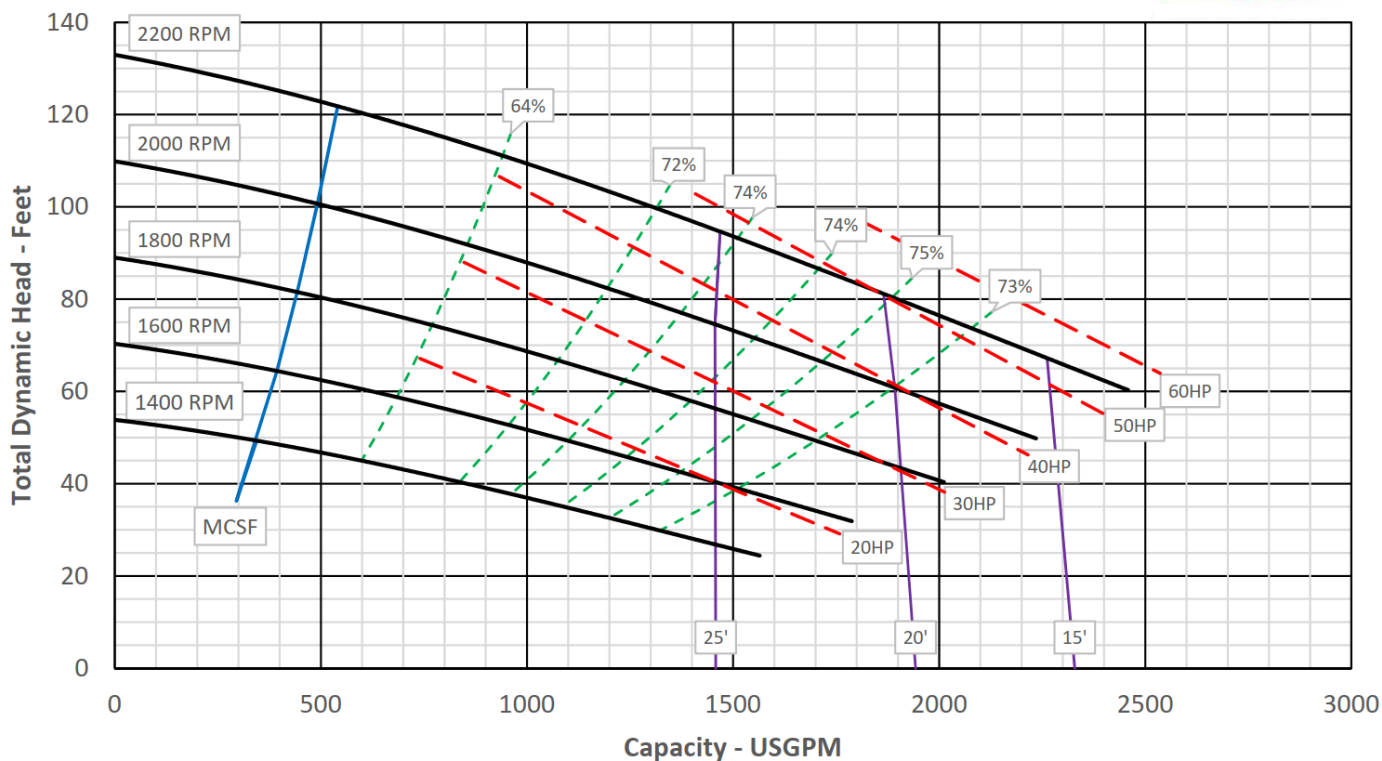

#### Isuzu 4LE2T—43 hp @ 2,400 rpm

Typical Operating Speed	2,000 rpm	Engine Speed	Fuel Economy	Run Time*
Maximum Head	110 ft (33.5 m)	2,200 rpm	0.390 lb/hp-hr	44 hrs
Maximum Flow Capacity	2,250 gpm (511 m <sup>3</sup> /hr)	2,000 rpm	0.386 lb/hp-hr	56 hrs
Maximum Fuel Consumption	2.22 gph (8.4 L/hr)	1,800 rpm	0.378 lb-hp-hr	74 hrs

\*Engine run times calculated based on a 100 gallon fuel tank.

Specifications and illustrations are subject to revision without notice and without incurring any obligation for previous or subsequent equipment sold. Thompson Pump (ISO 9001:2015) makes no representation regarding the completeness or accuracy of this information and is not liable for any direct or indirect damages arising from or relating to this information or its use. Capacity & Head are shown for comparative purposes. Consult Thompson factory for exact capabilities.